

GEAR PUMP



Series Gear Pump & Asphalt Pump

KCB

2CY

YCB

YCB-G



Approvals
Quality System Registration

ISO9001
Certified Manufacturer

New range of gear pumps for the new millenium

2015 | 2016

YUEMA

PUMP

XA SERIES



XA Pump
Stainless Steel



XA Pump

Design	: Performance and dimensions referring to the European standard BS En733/ DIN24255.
Structure	: Horizontal, Axial End-Suction, Single-Stage, Single-Suction, Volute Casing, Back pull-out, Centrifugal Pump
Flange	DIN2501(ISO7005.2 or GB/T17241.6 PN1.6) standard, ANSI B16.5 Class150lb optional
Rotation	: Clockwise viewing from the drive side
MATERIAL	Casing : Cast Iron standard, Ductile Iron, Stainless Steel optional Impeller : Bronze standard, Cast Iron, Stainless Steel optional Shaft : ASTM420 standard, ASTM304, ASTM316, ASTM1045 optional Shaft Seal : Mechanical Seal standard (Carbon-Ceramic/Nition standard, Caron-Sic/Won optional, Gland Packing optional)
OPERATING RANGE	Flow Rate (Q) : 2-1100m ³ /h Head (H) : 2-150m Speed : 1450 or 2900 rpm (50Hz) Temperature : 1750 or 3500 rpm (60Hz) Working : 10°C to 105°C, 10 Bar standard, 16 Bar on request

Application

- XA is used for handling clear water of the liquids similar to the water physically and chemically finding the applications for water feed and supply service in mine, plants and towns. air-conditioning, extinguishing and irrigation.
- In spite of the same specification, the pump's performances vary with the diameter of the impeller. (indicated with the block letters A, B and C in the end of the designation of the type.)
- The pump is simple in structure, reliable in performances. small in size, low in power consumption, convenient in maintenance and of good cavitation proof.
- XA has 60 specifications with the shaft in four sizes, suitable for various handling duties. For the pump with a same specification, the components, such as shaft, bearings, shaft sleeve, shaft seal and the fasteners of impeller are interchangeable. In addition, only live types of hearing brackets are applied to the whole series.

Specifications

Speed	: 2900r/min, 1450r/min or 1480r/min
Max. Capacity	: 132L/s 300L/s
Max. Head	: 155m 58m
Max. Speed	: 3500r/min. (when using the power of 60Hz. the dia. of impeller is reduced.)
Max. Working Temperature	: 105°C
Shaft Seal	: Packing or mechanical seal
Min. Working Temperature	: -10°C
Working Pressure	: Generally it is 1 Mpa. while the parts of undertaking pressure of XA40132G, XA50/326, XA65/326, XA80/32(l are fabricated with nodular cast iron or cast steel, it can increase to 1.6Mpa. When needed to apply to the other pumps. please state in the order.
Applicable Standard	: Q/FP 2101-2002

KENFLO®

KENFLO PUMP



XA Oil



XA Grase



XA
Stainless Steel

XO pump series

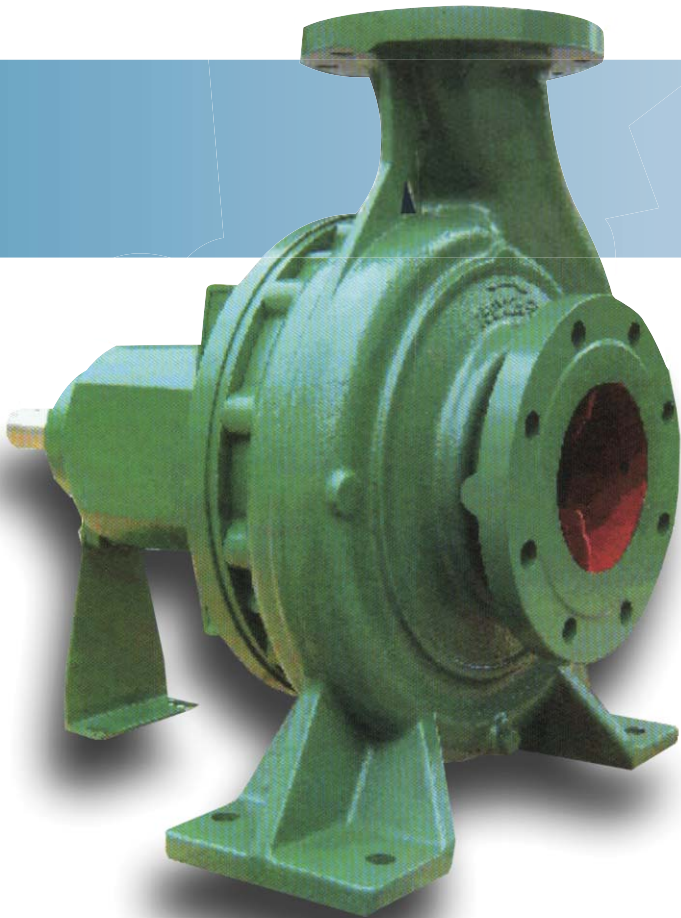

High Efficiency

ISO 2858 / 5199 Standard

Application

- Circulation of liquids
- Condenser water
- Heating water
- Irrigation
- HVAC
- Dewatering
- Mineral processing
- Dust suppression
- Chemical transfer

Design Features

This pump includes the back pull-out design, and when a suitable spacer coupling is fitted to a direct coupled unit, the casing and motor can remain in position while all other pump parts can be removed for simple and quick maintenance.

The volute casing is fitted with a replaceable wear ring and has a suction vane to give smooth flow into the double shrouded hydraulically balanced impeller.

Only five shaft assemblies are required to cover the total range and this gives many common interchangeable parts for pumps fitted to the same shaft.

The standard pump is fitted with a mechanical seal chamber.

Pumps can be supplied as a bare shaft unit, or in many other arrangements, including complete with coupling, guard, base plate and either electric motor or engine.

Technical Information

36 Sizes in the range
Capacity to 1600 m³/h
Head to 160 m

Maximum Temperature

With standard mechanical seal 10°C to 140°C.

Maximum Pressure

Operating pressure 1.6 Mpa to 2.4 Mpa
Maximum test pressure 3.6 Mpa.

Maximum Speed

Maximum direct coupled Speed for pumps varies between 3600 RPM and 1500 RPM depending upon pump size and method of drive.

KCB SERIES GEAR PUMP

1. Application

It applies to delivering non-corrosive lubricating-oil or equivalent liquid without solid particles and fibres at temperature below 80°C and with the viscosity of $5 \times 10^{-6} \sim 1.5 \times 10^{-3} \text{ m}^2/\text{s}$ (5-1500cSt).

2. Application Scope

It can give performance as transfer pump or booster pump in oil delivery system. It can be also applied as a fuel pump for delivery system, pressurization and injection in fuel supply system and in all industry fields as lubricating pump.



3. Structure Features

- KCB Series gear pumps are mainly composed of gears, axles, pump body, pump cap safety valve and axle-end seals etc. The heat-treated gears have the advantage of higher hardness and intensity, and rotate with the axles inside the replaceable bearing sleeves. All of pump's part can be lubricated by delivered medium when working.
- The pump is properly designed with leakage and return chute, which lets the gears bear the least torque force and reduces load and wear on bearings in order to raise pump's efficiency.
- It is also designed with safety valve for protection against overload, The full return flow Pressure of the safety valve is 1.5 times higher than the rated exhaust pressure of the pump, It can be also adjusted within the allowance of exhaust pressure range according to circumstances. But please note the safety valve can't be applied as pressure reducing valve for long time. You may install pressure-reducing valve separately on pipe-line if needed

2CY SERIES GEAR PUMP

1. Application

It applies to delivering non-corrosive lubricating-oil or equivalent liquid without solid particles and fibres at temperature below 80°C and with the viscosity of $5 \times 10^{-6} \sim 1.5 \times 10^{-3} \text{ m}^2/\text{s}$ (5-1500cSt).

It applies to hydraulic system, too.

2. Application Scope

It can give performance as transfer pump or booster pump in oil delivery system, and a fuel pump for delivery, pressurization and injection in fuel supply system. It can be also applied as hydraulic pump supplying hydraulic power in hydraulic system and in all industry fields as lubricating pump.

3. Structure Features

- 2CY series gear pumps are mainly composed of gears, axles, pump body, pump cap, bearing sleeves and axle-end seals, etc. The nitriding-treated gears have the advantage of higher hardness and wear property, and they rotate with the axles inside the replaceable bearing sleeves. All of pump's parts can be lubricated by delivered medium when working.
- Four bearing sleeves are installed suspended in pump body and can be automatically adjusted with facing gaps clearance complying with pressure change, therefore, it results in stable pump pressure, little discharge, flow pulsation and higher volume efficiency.





YCB SERIES GEAR PUMP

1. Application

It applies to delivering non-corrosive lubricating-oil or equivalent liquid without solid particles and fibres at temperature below 80°C and with the viscosity of $5 \times 10^{-6} \sim 1.5 \times 10^{-3} \text{ m}^2/\text{s}$ (5-1500cSt). It applies to hydraulic system, too.

2. Application Scope

It can give performance as transfer pump or booster pump in oil delivery system, and a fuel pump for delivery, pressurization and injection in fuel supply system. It can be also applied as hydraulic pump supplying hydraulic power in hydraulic system and in all industry fields as lubricating pump.

3. Structure Features

- 2CY series gear pumps are mainly composed of gears, axles, pump body, pump cap, bearing sleeves and axle-end seals, etc. The gears are adopted double circular teeth shape, which makes the gears less wear on gear surface, stable revolution, low noise, long service life and high efficiency, due to no sliding on the teeth during gear falling-in. This kind of pump has got rid of traditional design and come into a new decade in designing and application.
- The pump is designed with safety valve for protection against overload. The full return flow pressure is 1.5 times higher than the rates exhaust pressure of the pump. It can be adjusted within the allowance of exhaust pressure range according to Circumstance. But please note the safety valve can't be applied as pressure-reducing valve for long time. You may install pressure-reducing valve separately on pipe-line if needed.
- There are two kinds of axle-end seals, mechanical seal and packing seal, which can be chosen according to the clients' requirements of application circumstance.

YCB-G ASPHALT PUMP

1. MODEL EXPLANATIONS

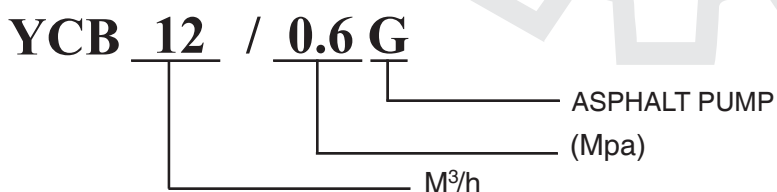

2. PERFORMANCE DATA

Model	mm	M ³ /h	Mpa	(NPSH) _r m	r/min
YCB 6/0.6G	40	6	0.6	6	960
YCB 10/0.6G	65	10	0.6	6	320
YCB 12/0.6G	65	12	0.6	6	383
YCB 25/0.6G	80	25	0.6	6	252
YCB 40/0.6G	80	40	0.6	6	417



DIAGRAM OF PERFORMANCE CURVE

Performance data of all gear pump have been defined on basis of the viscosity of $4 \times 10^{-3} \text{m}^2/\text{s}$ (40cSt). The data indicated in the performance diagram is suitable to medium viscosity of $1 \times 10^{-5} \sim 8 \times 10^{-5} \text{m}^2/\text{s}$ (10~80cSt). Of which exceeds the above viscosity, the data will be re-defined according to client's demands.

The given exhausting pressure of all gear pumps is the highest working pressure, and pumps can perform normally within range of the rated working pressure, which can be found in diagram No.1

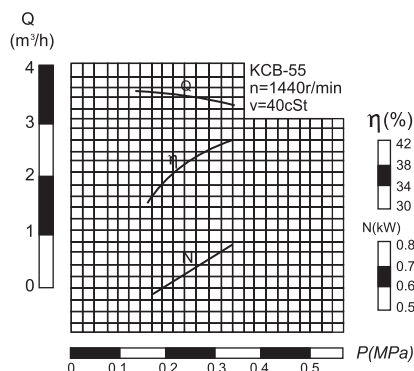

KCB-55
Diagram of performance Curve of Model KCB-55 Gear pump

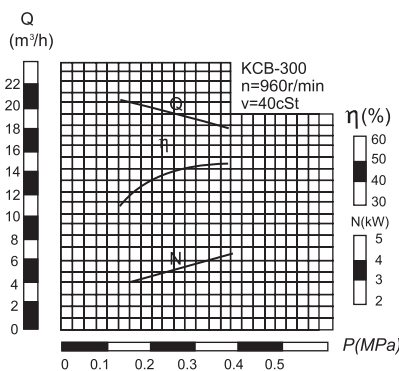

KCB-300
Diagram of performance Curve of Model KCB-300 Gear pump

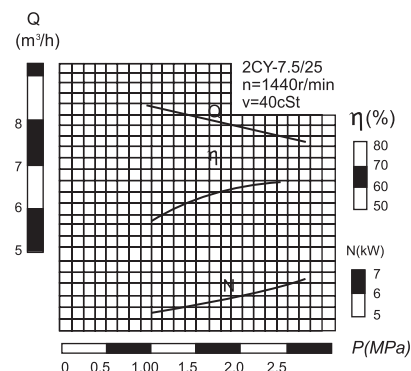

2CY-7.5/25
Diagram of performance Curve of Model 2CY-7.5/25 Gear pump

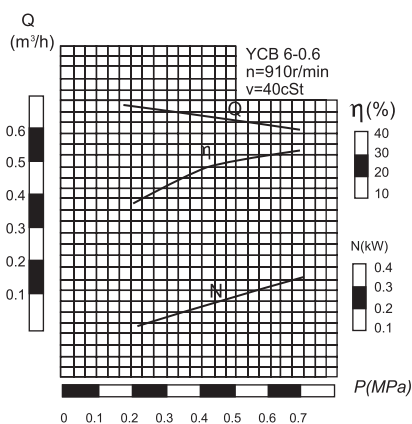

YCB 6-0.6
Diagram of performance Curve of Model YCB 6-0.6 Gear pump

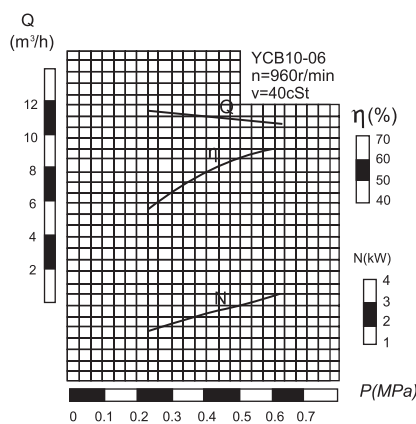

YCB 10-0.6
Diagram of performance Curve of Model YCB 10-0.6 Gear pump

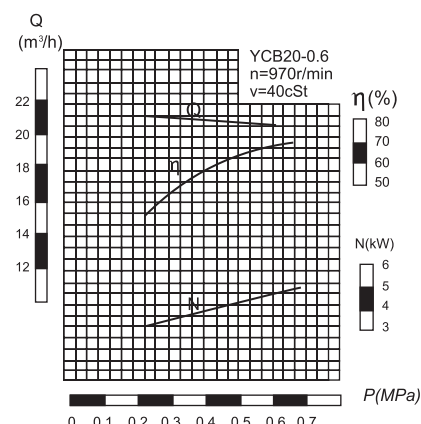

YCB 20-0.6
Diagram of performance Curve of Model YCB 20-0.6 Gear pump

WORKING SCOPE(DIAGRAM NO.1)

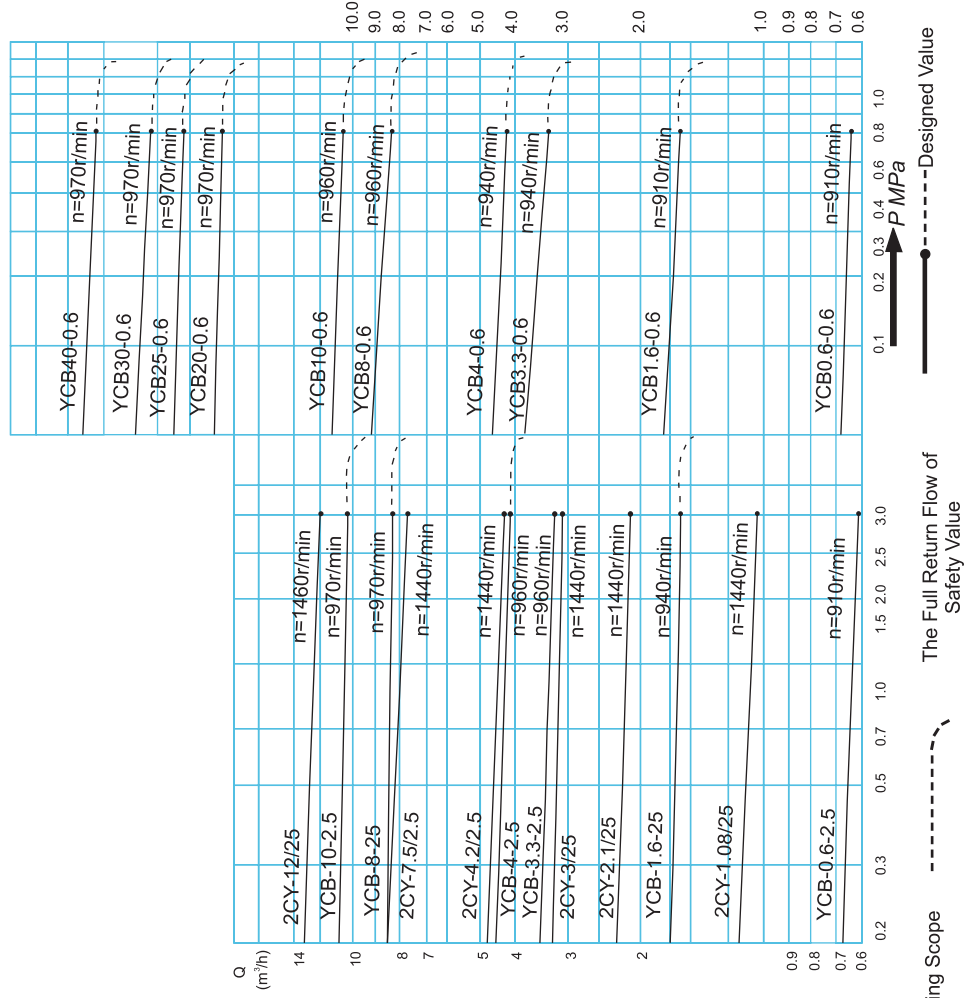
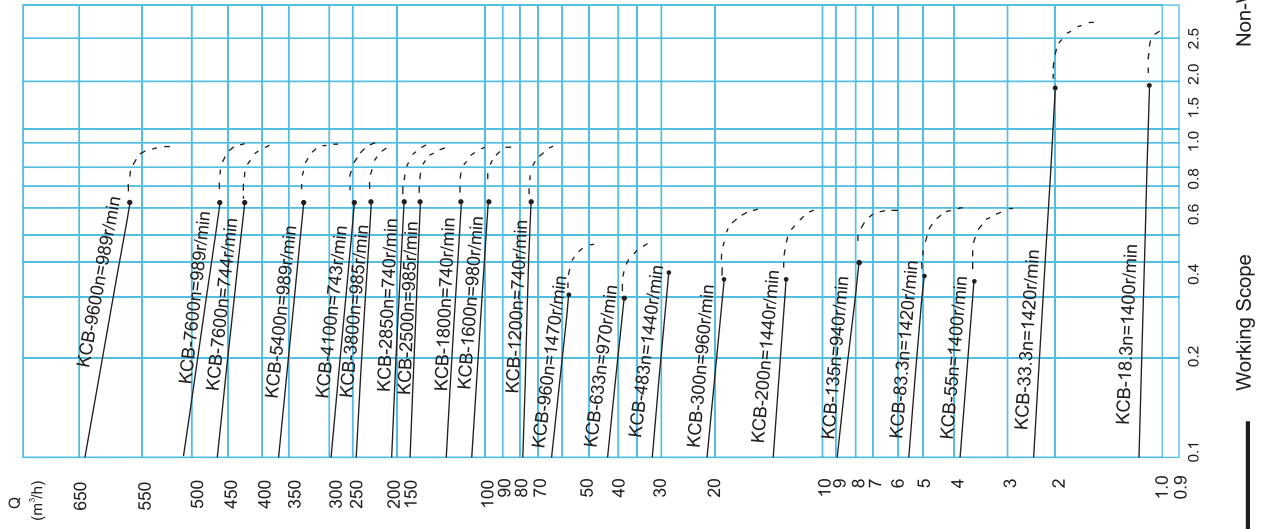

KCB FUNCTIONAL DATA OF KCB SERIES GEAR PUMPS

Model	Capacity Q		Speed n r/min	Exhaust Pressure P MPa	(NPSH) _r m	Efficiency η %	Motor	
	m ³ /h	L/min					kW Power	Model
KCB-18.3 2CY-1.1/1.45	1.1	18.3	1400	1.45	5	44	1.5	Y90L-4
KCB-33.3 2CY-2/1.45	2	33.3	1420	1.45	5	44	2.2	Y100L1-4
KCB-55 2CY-3.3/0.33	3.3	55	1400	0.33	7	41	1.5	Y90L-4
KCB-83.3 2CY-5/0.33	5	83.3	1420	0.33	7	43	2.2	Y100L1-4
KCB-135 2CY-8/0.33	8	135	940	0.33	5	46	2.2	Y112M-6
KCB-200 2CY-12/0.33	12	200	1440	0.33	5	46	4	Y112M-4
KCB-300 2CY-18/0.36	18	300	960	0.36	5	42	5.5	Y132M2-6
KCB-483.3 2CY-29/0.36	29	483.3	1440	0.36	5.5	42	11	Y160M-4
KCB-633 2CY-38/0.28	38	633	970	0.28	6	43	11	Y160L-6
KCB-960 2CY-58/0.28	58	960	1470	0.28	6.5	43	18.5	Y180M-4
KCB-1200	72	1200	740	0.6	7	43	37	Y280S-8
KCB-1600	95	1600	980				45	Y280S-6
KCB-1800	112	1800	740	0.6	7.5	43	55	Y315S-8
KCB-2500	150	2500	987				75	Y315S-6
KCB-2850	170	2850	740	0.6	8	44	90	Y315L1-8
KCB-3800	230	3800	989				110	Y315L1-6
KCB-4100	245	4100	743	0.6	8	44	132	Y355M1-8
KCB-5400	325	5400	989				160	Y355M1-6
KCB-5600	330	5600	744	0.6	8	44	160	Y355M2-8
KCB-7600	460	7600	989				200	Y355M3-6
KCB-7000	420	7000	744	0.6	8	44	185	Y355L1-8
KCB-9600	570	9600	989				250	Y355L2-6

2CY FUNCTIONAL DATA OF 2CY SERIES GEAR PUMPS

Model	Capacity Q		Speed n r/min	Exhaust Pressure P MPa	(NPSH) _r m	Efficiency η %	Motor	
	m ³ /h	L/min					kW Power	Model
2CY-1.08/2.5	1.08	18	1420	2.5	9.5	58	2.2	Y100L1-4
2CY-2.1/2.5	2.1	35	1420	2.5	9.5	58	3	Y100L2-4
2CY-3/2.5	3	50	1440	2.5	9.5	59	4	Y112M-4
2CY-4.2/2.5	4.2	70	1440	2.5	9.5	59	5.5	Y132S-4
2CY-7.5/2.5	7.5	125	1440	2.5	9.5	63	7.5	Y132M-4
2CY-12/2.5	12	200	1460	2.5	9.5	63	15	Y160L-4

YCB FUNCTIONAL DATA OF YCB SERIES CIRCULAR TEETH GEAR PUMPS

Model	Capacity Q m ³ /h	Speed n r/min	Exhaust Pressure P MPa	(NPSH) _r m	Efficiency η %	Motor		
						Hz	kW Power	Model
YCB0.6-0.6	0.6	910	0.6	5.5	32	50	0.75	Y90S-6
	1.0	1390				50	0.75	Y80L2-4
	0.7	1130				60	0.75	Y90S-6
	1.2	1710				60	0.75	Y80L2-4
YCB0.6-1.6	0.6	910	1.6	7.0	70	50	1.1	Y90L-6
	1.0	1400				50	1.5	Y90L-4
	0.7	1130				60	1.1	Y90L-6
	1.2	1710				60	1.1	Y90S-4
YCB1.6-0.6	1.6	910	0.6	5.5	42	50	0.75	Y90S-6
	2.5	1400				50	1.1	Y90S-4
	1.9	1130				60	1.1	Y90L-6
	3.0	1710				60	1.5	Y90L-4
YCB1.6-1.6	1.6	940	1.6	7.0	71	50	2.2	Y112M-6
	2.5	1440				50	4	Y112M-4
	1.9	1150				60	2.2	Y112M-6
	3.0	1750				60	4	Y112M-4
YCB3.3-0.6	3.3	940	0.6	5.0	60	50	1.5	Y100L-6
	5.0	1420				50	22	Y100L1-4
	4.0	1150				60	1.5	Y100L-6
	6.0	1730				60	2.2	Y100L1-4
YCB3.3-1.6	3.3	960	1.6	7.0	72	50	5.5	Y132M2-6
	5.0	1440				50	7.5	Y132M-4
	4.0	1170				60	4	Y132M1-6
	6.0	1750				60	7.5	Y132M-4
YCB4-0.6	4.0	940	0.6	5.0	60	50	1.5	Y100L-6
	6.0	1420				50	2.2	Y100L1-4
	4.8	1150				60	2.2	Y112M-6
	7.2	1730				60	3	Y100L2-4
YCB4-1.6	4.0	960	1.6	7.0	72	50	5.5	Y132M2-6
	6.0	1440				50	7.5	Y132M-4
	4.8	1170				60	5.5	Y132M-6
	7.2	1750				60	7.5	Y132M-4
YCB8-0.6	8.0	960	0.6	5.0	61	50	3	Y132S-6
	12.0	1440				50	5.5	Y132S-4
	9.6	1170				60	4	Y132M1-6
	14.4	1750				60	5.5	Y132S-4
YCB8-1.6	8.0	970	1.6	7.0	75	50	11	Y160L-6
	12.0	1460				50	15	Y160L-4
	9.6	1170				60	11	Y160L-6
	14.4	1760				60	15	Y160L-4
YCB10-0.6	10.0	960	0.6	5.0	62	50	4	Y132M1-6
	15.0	1440				50	5.5	Y132S-4
	12.0	1170				60	5.5	Y132M2-6
	18.0	1750				60	7.5	Y132M-4
YCB10-1.6	10.0	970	1.6	7.0	76	50	11	Y160L-6
	15.0	1470				50	15	Y160L-4
	12.0	1170				60	11	Y160L-6
	18.0	1770				60	18.5	Y180M-4
YCB20-0.6	20.0	970	0.6	5.0	68	50	7.5	Y160M-6
	24.0	1170				60	7.5	Y160M-6
YCB25-0.6	25.0	970	0.6	5.5	69	50	11	Y160L-6
	30.0	1170				60	11	Y160L-6
YCB30-0.6	30.0	970	0.6	5.5	70	50	11	Y160L-6
	36.0	1170				60	11	Y160L-6
YCB40-0.6	40.0	970	0.6	5.5	72	50	15	Y180L-6
	48.0	1180				60	15	Y180L-6
YCB50-0.6	50.0	970	0.6	5.5	72	50	22	Y200L2-6
	60.0	1180				60	22	Y200L2-6

KCB 18.3 ~ 83.3 GEAR PUMP APPERANCE & INSTALLATION DIMENSION

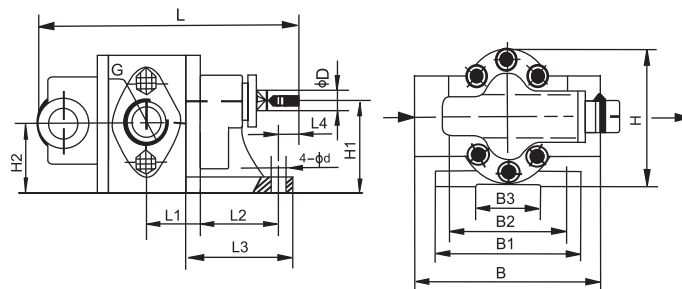

Model	L	L1	L2	L3	L4	B	B1	B2	B3	H	H1	H2	ØD	G	4-ØD
KCB-18.3	217.5	35	80	115	16	192	150	120	66	136	90	69	20	G 3/4"	16
KCB-33.3	231	42.5	80	115	16	192	150	120	66	136	90	69	20	G 3/4"	16
KCB-55	246	50	80	115	16	192	150	120	66	136	90	69	20	G 1"	16
KCB-83.3	271	62	80	115	16	192	150	120	66	136	90	69	20	G 1 1/2"	16

KCB 200 ~ 960 GEAR PUMP APPERANCE & INSTALLATION DIMENSION

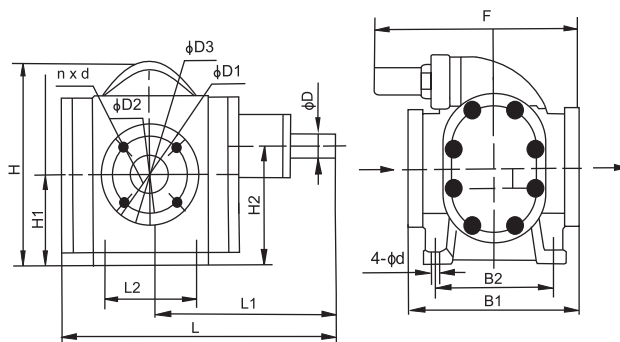

Model	L	L1	L2	BI	B2	H	H1	H2	F	ØD1	ØD2	ØD3	nxd	ØD	4-ØD
KCB-200	290	200	66	214	160	263.5	118	152.5	300	140	110	50	4-M12	28	13
KCB-300	354	230	90	225	180	308	128	170	318	155	123	70	6-M14	32	16
KCB-483.3	354	230	90	225	180	308	128	170	318	155	123	70	6-M14	32	16
KCB-633	415	270	120	280	175	385	188	205	380	190	158	100	8-M14	38	18
KCB-960	415	270	120	280	175	385	188	205	380	190	158	100	8-M14	38	18

KCB 1200 ~ 9600 GEAR PUMP APPERANCE & INSTALLATION DIMENSION

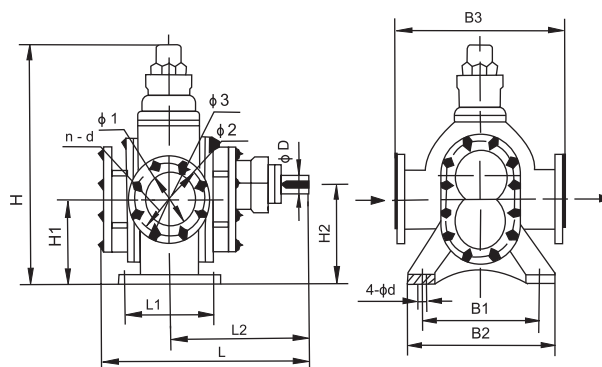

Model	L	L1	L2	B1	B2	B3	H	H1	H2	ØD1	ØD2	ØD3	nxd	ØD	4-ØD
KCB-1200	715	300	480	415	463	510	708	220	300	150	225	260	8-Ø18	56	25
KCB-1600															
KCB-1800	830	340	547	460	585	684	876	262	350	200	280	320	8-Ø18	76	25
KCB-2500															
KCB-2850	948	380	625	520	584	640	915	299	400	250	335	370	12-Ø18	86	25
KCB-3800															
KCB-4100															
KCB-5600	1085	345	700	500	600	740	1155	386	500	350	445	490	12-Ø23	95	32
KCB-7000															
KCB-7600															
KCB-9600															

2CY TYPE GEAR PUMP APPERANCE & INSTALLATION DIMENSION

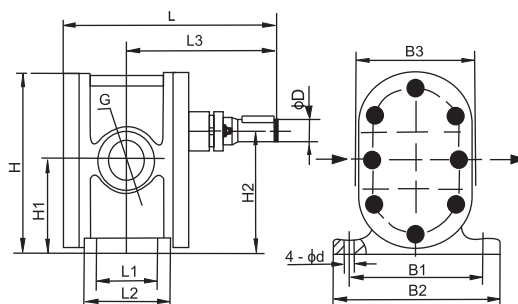

Model	L	L1	L2	L3	B1	B2	B3	H	H1	H2	G	ØD	4-ØD
2CY-1.08/2.5	193.5	45	75	138.5	114	138	95	132	67.5	87	G 3/4"	18	10
2CY-2.1/2.5	198.5	48	78	142.5	124	154	110	164.5	86	112	G 1"	18	10
2CY-3/2.5	198.5	48	78	142.5	124	154	110	164.5	86	112	G 1"	18	10
2CY-4.2/2.5	220	58	88	155	160	190	140	205	107.5	140	G 1 1/4"	28	12
2CY-7.5/2.5	239	65	98	164.5	160	190	140	205	107.5	140	G 1 1/2"	28	12
2CY-12/2.5	360	106	136	257	190	220	210	256	136	178	G 2"	32	14

YCB TYPE GEAR PUMP APPERANCE & INSTALLATION DIMENSION

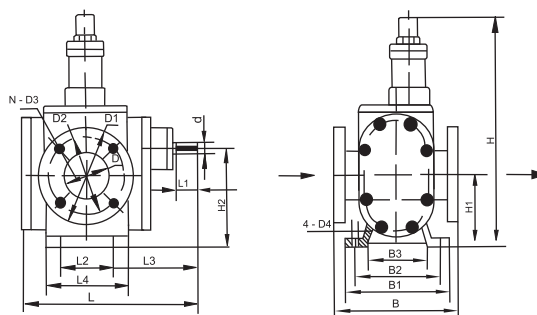

Model	L	L1	L2	L3	L4	B	B1	B2	B3	H	H1	H2	D	D1	D2	N-D3	4-D4	d
YCB0.6	180	30	45	107.5	66	125	91	70	35	187	80	92	Ø25	Ø100	Ø75	4-M10	4-Ø9	Ø12
YCB1.6	208	32	55	118.5	80	150	115	90	50	208	79.7	95	Ø32	Ø120	Ø90	4-Ø14	4-Ø11	Ø14
YCB3.3	247.6	35	70	132.85	98	180	148	120	75	258	87.6	110	Ø40	Ø130	Ø100	4-Ø14	4-Ø13	Ø18
YCB4	260.6	35	80	134.8	108	180	148	120	75	263	92.6	115	Ø50	Ø140	Ø110	4-Ø14	4-Ø13	Ø18
YCB8	313	45	100	158.5	138	220	178	140	90	361	105	135	Ø65	Ø160	Ø130	4-Ø14	4-Ø13	Ø24
YCB10	330	45	100	168.5	138	220	178	140	90	360	105	135	Ø65	Ø160	Ø130	4-Ø14	4-Ø13	Ø24
YCB20	400	55	135	201	182	260	226	180	118	436.5	130.8	170	Ø80	Ø190	Ø150	4-Ø18	4-Ø18	Ø32
YCB25	430	55	135	216	182	260	226	180	118	436.5	130.8	170	Ø100	Ø210	Ø170	4-Ø18	4-Ø18	Ø32
YCB30	459	60	150	236	200	275	231	190	126	461	141	185	Ø100	Ø210	Ø170	4-Ø18	4-Ø18	Ø35
YCB40	500	70	175	251.5	225	300	260	210	140	509	157	205	Ø125	Ø240	Ø200	8-Ø18	4-Ø18	Ø40
YCB50	493	70	175	246.5	225	300	260	210	140	509	157	205	Ø125	Ø240	Ø200	8-Ø18	4-Ø18	Ø40

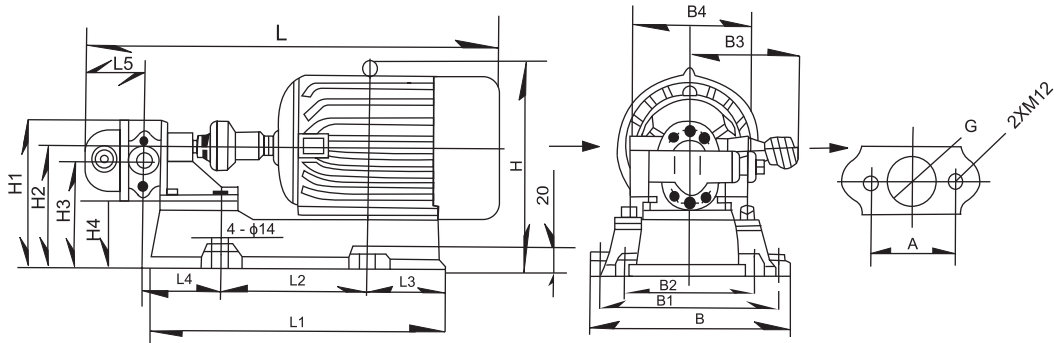
KCB-18.3 ~ KCB-83.3 GEAR PUMP APPERANCE & INSTALLATION DIMENSION AND WEIGHT

Model	L	L1	L2	L3	L4	L5	H	H1	H2	H3	H4	B	B1	B2	B3	B4	A	G	Weight(kg)
KCB-18.3	566	391	239	86	75	86	230	176	130	109	40	259	225	190	155	192	52	G3/4"	62.15
KCB-33.3	618	416	256	86	82	93	285	186	140	119	50	279	245	190	180	192	52	G3/4"	66.8
KCB-55	595	391	239	86	89.5	100.5	230	176	130	109	40	259	225	190	155	192	70	G1"	64.15
KCB-83.3	652	416	256	94	102	113	285	186	140	119	50	279	245	190	180	192	78	G13/2"	70.15

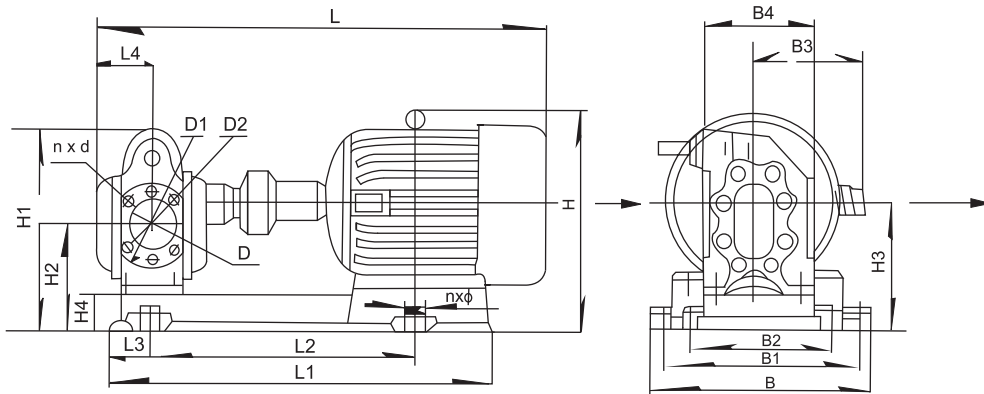
KCB-200 ~ KCB-960 GEAR PUMP APPERANCE & INSTALLATION DIMENSION AND WEIGHT

Model	L	L1	L2	L3	L4	nxØ	H	H1	H2	H3	H4	B	B1	B2	B3	B4	D	D1	D2	nxd	Weight(kg)
KCB-200	709	577	419	58	90	4xØ16	355	314	168	202	50	326	290	240	190	214	Ø50	Ø110	Ø140	4xM12	135
KCB-300	883	715	502	80	124	4xØ22	423	378	198	240	70	390	340	280	210	228	Ø70	Ø123	Ø155	6xM14	175
KCB-483.3	972	795	565	80	124	4xØ22	465	378	198	240	70	450	400	290	255	228	Ø70	Ø123	Ø155	6xM14	213
KCB-633	1074	901	629	100	145	4xØ22	500	455	258	275	70	450	400	285	255	280	Ø100	Ø158	Ø190	8xM14	274.5
KCB-960	1099	900	635	100	145	4xØ22	525	455	258	275	70	470	420	285	285	280	Ø100	Ø158	Ø190	8xM14	304.5

**2CY-1.08/2.5 ~ 2CY-12/2.5
2CY-1.08/2.5 ~ 2CY-12/2.5 GEAR PUMP APPERANCE & INSTALLATION DIMENSION AND WEIGHT**

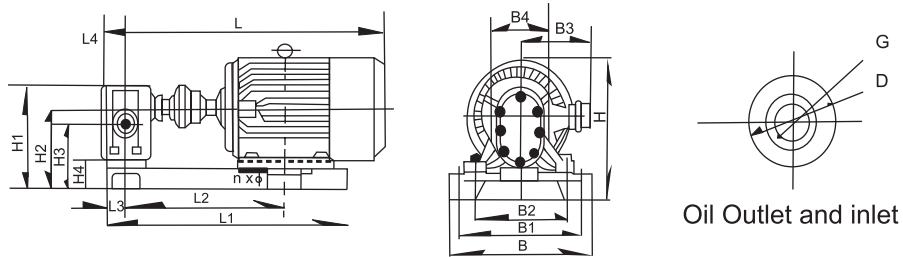

Model	L	L1	L2	L3	L4	H	H1	H2	H3	H4	B	B1	B2	B3	B4	G	D	nxØ	Weight(kg)
2CY-1.08/2.5	582	486	339	47.5	55	290	190	145	125.5	58	293	257	190	180	95	G3/4"	Ø36	4xØ18	56
2CY-2.1/2.5	586	493	344	49	56	302	210	157	131	45	293	257	206	180	110	G1"	Ø50	4xØ18	63.5
2CY-3/2.5	605	499	349	49	56	310	210	157	131	45	333	297	206	190	110	G1"	Ø50	4xØ18	77.5
2CY-4.2/2.5	720	585	420	54	65	373	255	190	157.5	50	368	332	242	210	140	G11/4"	Ø70	4xØ18	121
2CY-7.5/2.5	780	637	448	60	75	378	260	195	162.5	55	368	332	242	210	140	G11/2"	Ø70	4xØ18	136
2CY-12/2.5	1020	862	616	78	103	468	321	243	201	65	416	380	272	255	210	G2"	Ø95	4xØ18	173

**KCB-1200 ~ KCB-9600
KCB-1200 ~ KCB-1200 GEAR PUMP APPERANCE & INSTALLATION DIMENSION**

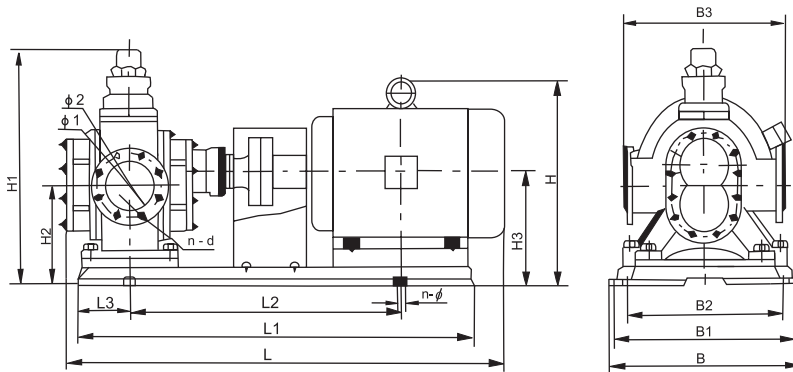

Model	L	L1	L2	L3	H	H1	H2	H3	B	B1	B2	B3	Ø1	Ø2	nxd	nxØ
KCB1200/0.6	1771	1470	990	194	780	828	340	420	683	631	621	510	Ø150	Ø225	8-Ø18	4-Ø25
KCB1600/0.6																
KCB1800/0.6	2036	1740	1142	230	1020	996	382	470	772	720	720	684	Ø200	Ø280	8-Ø18	4-Ø25
KCB2500/0.6																
KCB2850/0.6	2294	1930	1250	270	1070	1035	419	520	810	750	750	640	Ø250	Ø335	12-Ø18	4-Ø30
KCB3800/0.6																
KCB4100/0.6	2524	2008	1340	270	1200	1035	419	520	1163	906	750	640	Ø250	Ø335	12-Ø18	4-Ø30
KCB5400/0.6																

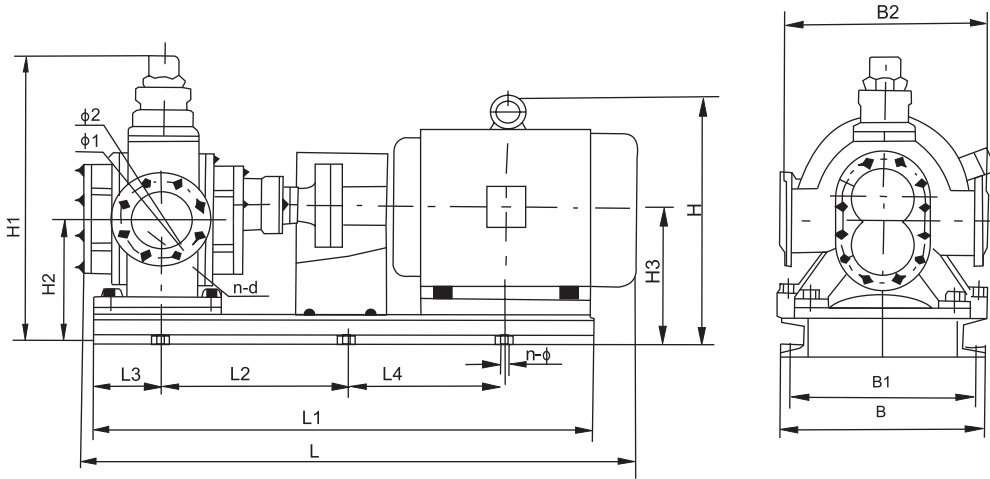

Model	L	L1	L2	L3	L4	H	H1	H2	H3	B	B1	B2	ØD1	ØD2	nxd	nxØ
KCB5600	2632	2090	723	245	723	1465	1440	671	785	760	690	740	Ø350	Ø445	12-Ø23	6-Ø32
KCB7000	2662	2090	723	245	723	1465	1440	671	785	760	690	740	Ø350	Ø445	12-Ø23	6-Ø32
KCB7600	2632	2090	723	245	723	1465	1440	671	785	760	690	740	Ø350	Ø445	12-Ø23	6-Ø32
KCB9600	2662	2090	723	245	723	1465	1440	671	785	760	690	740	Ø350	Ø445	12-Ø23	6-Ø32

YCB TYPE GEAR PUMP APPERANCE & INSTALLATION DIMENSION & WEIGHT

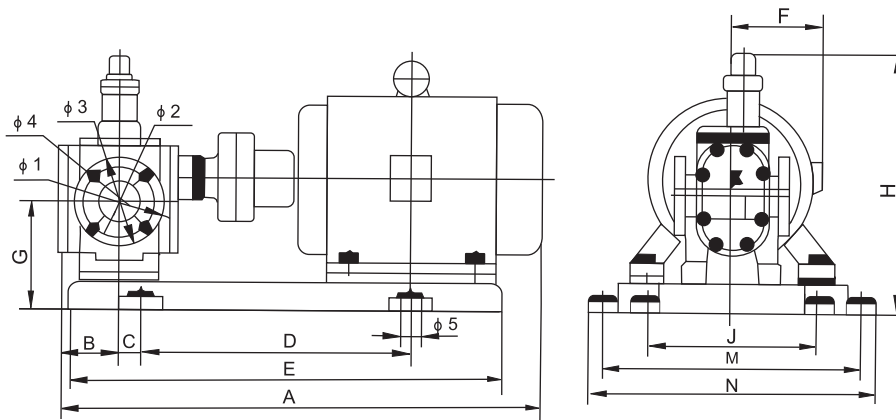

Model	M ³ /h	A	B	C	D	E	F	G	H	J	K	M	N	Ø1	Ø2	Ø3	nxØ4	nxØ5	weight	
YCB0.6-0.6	0.6	506			280	421	155		232	136	125	222	252	Ø25	Ø75	Ø100	4xM10		38.5	
YCB1.0-0.6	1.0	486.5	50	22.5	264	405	150	115	217			207	237					4xØ14		
YCB1.6-0.6	1.6								243	156	150	222	252	Ø32	Ø90	Ø120			43	
YCB2.5-0.6	2.5	547	63	27.5	303	455	155													
YCB3.3-0.6	3.3	644	76	35	344.5	544.5		180	127.6	298	198	180	266	298	Ø40	Ø100	Ø130		65	
YCB5.0-0.6	5												256	288	Ø50	Ø110	Ø140	4xØ14		
YCB4.0-0.6	4	667.5	82	40	346	557													66	
YCB6.0-0.6	6																			
YCB8.0-0.6	8	795	101		382	644													117	
YCB12-0.6	12			50				210	140	396	218	220	332	364	Ø65	Ø130	Ø160			
YCB10-0.6	10	849			430	690													130	
YCB15-0.6	15	808	111		392	652														
YCB20-0.6	20	1009	131.5	29.5	566	845		165.8	471.5	270	260	380	416	Ø80	Ø150	Ø190			216	
YCB25-0.6	25	1100	146.5		603	904	255					385	421					4xØ18	4xØ18	223
YCB30-0.6	30	1125	147	35	646	954		196	517	295	275	400	436	Ø100	Ø170	Ø210			288	
YCB40-0.6	40	1214	161	42.5	673	1023	285	212	562	315	300	425	461	Ø125	Ø200	Ø240	8xØ18	4xØ18	364	
YCB50-0.6	50	1300	159	52.5	680	1080	310	237	590	340	300	476	536	Ø125	Ø200	Ø240	8xØ18	4xØ22		



SIHI'S PUMP
MADE IN GERMANY

PROFESSIONAL QUALITY PUMPS

Application

- Waterworks, and water supply
- Boiler feed
- Pressure boosting
- Irrigation
- Filtration
- High pressure cleaning
- Heating
- Condensate systems
- Reverse osmosis
- Water treatment plants
- and many more ...

Technical Data

Flowrate:	max. 75 m ³ /h
Head:	max. 250 m
Speed:	max. 3600 rpm
Temperature:	-15 to +120°C
Pressure Rating:	max. 25 bar
Shaft seal:	mechanical seal
Direction	clockwise, when viewed from motor side



Product :

YUEMA
ELECTRIC MOTOR

TransmaX

Elektrim[®]
CANTONI
MOTOR
Made in Poland

YUEMA
GEAR PUMP

speck
pumpen
Made In Germany

SIHI
SIHI'S PUMP
MADE IN GERMANY

Southern Cross
Made in Australia

Revvo
Castor and Wheel
Made In England

ORIENTAL KOSHIN
Made in Japan

KENFLO[®]
PUMP DIVISION
Made in CHINA

REVCO

FCL
COUPLING

quantum
VIBRATOR

Bishamon[®]
Made in Japan

PRESTAR[®]
Made in japan

DELTA
DELTA ELECTRONICS, INC.



PT. RODA ROLLEN INDONESIA is a supplier for Mechanical dan Electrical engineering product for modern general industries. The company was established in 1998 and since then has become a stockist and representatives agents for many leading brands in industrial engineering from around the world such as :

- REVVO CASTOR AND WHEELS UK
- CANTONI MOTORS POLAND
- SOUTHERN CROSS AUSTRALIA
- SPECK PUMPEN GERMANY
- BISHAMON JAPAN
- KOSHIN JAPAN
- DELTA AUTOMATIONS TAIWAN
- And many more.

Our objective is to be a reliable main partner for Indonesian industries by supplying a wide range of high quality products to ensure high efficiency result.

PT. RODA ROLLEN INDONESIA adalah pemasok produk Mekanik dan Elektrik di bidang teknik untuk industri umum yang maju. Perusahaan ini didirikan pada tahun 1998 dan sejak itu telah menjadi stockist dan agen perwakilan untuk merek-merek terkemuka di bidang teknik industri dari seluruh dunia seperti:

- REVVO CASTOR AND WHEELS UK
- CANTONI MOTORS POLAND
- SOUTHERN CROSS AUSTRALIA
- SPECK PUMPEN GERMANY
- BISHAMON JAPAN
- KOSHIN JAPAN
- DELTA AUTOMATIONS TAIWAN
- Dan lain lain.

Tujuan kami adalah untuk menjadi mitra utama yang dapat diandalkan untuk para industri di Indonesia dengan cara menyediakan berbagai macam produk berkualitas tinggi untuk memastikan hasil efisiensi yang tinggi.